

# INSTALLATION INSTRUCTIONS FOR TMC HEAVY DUTY MARINE WIPER

THERE ARE TWO KINDS OF TMC HEAVY DUTY WIPERS, TMC-009AS AND TMC-009B, THE STALL TORQUE OF TMC-009AS IS 180 KG-CM AND THE TORQUE OF TMC-009B IS 100 KG-CM. THESE TWO KINDS OF WIPERS ALL HAVE TWO DIFFERENT TYPE, ONE IS ONLY ONE SPEED ANOTHER IS TWO SPEED THESE TWO WIPERS ALL CAN BE ADJUSTED FOR 83°, 100°, 110° & 120° WIPING ANGLES, AND THEY ARE ALL SELF-PARKING TYPE.

1. THE OVERALL DIMENSIONS OF WIPER MOTOR ARE AS ILLUSTRATED.

2. LOCATE MOUNTING POSITION OF WIPER; DETERMINE, SUITABLE SWEEPING DEGREES AND WHETHER ADEQUATE SPACE IS AVAILABLE. SEE THAT BLADE WILL WIPE THE DESIRED AREA OF WINDSHIELD. REFER TO SWEEPING DIAGRAM.

## WIRING DIAGRAM

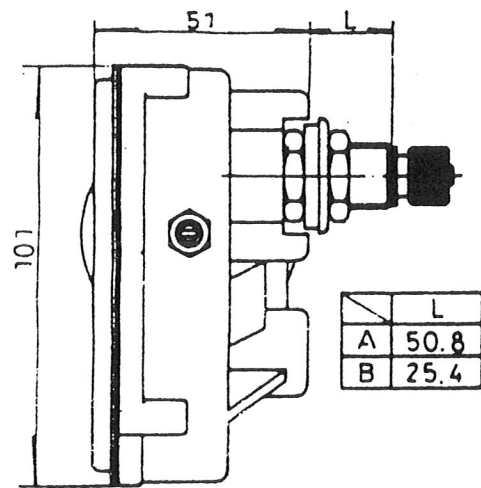
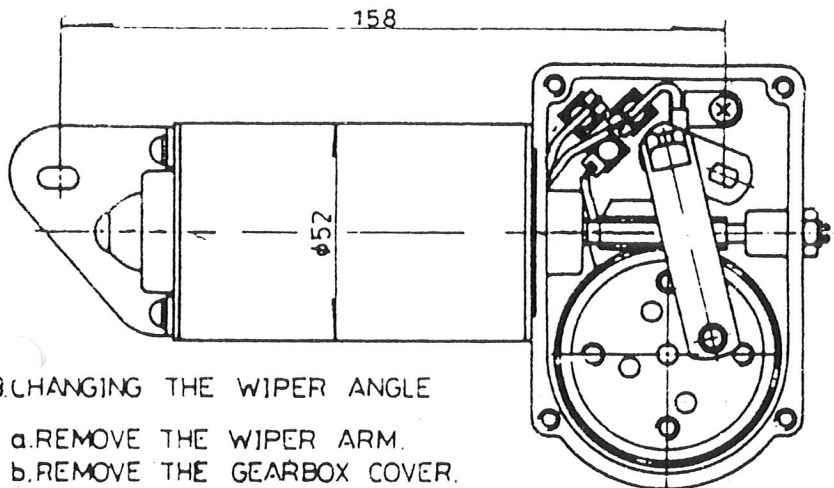
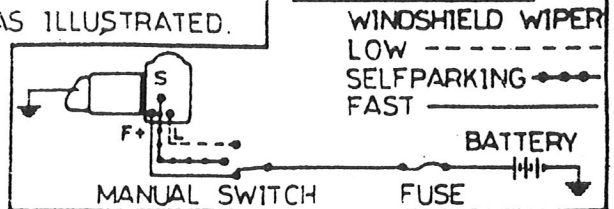

## 3. CHANGING THE WIPER ANGLE

- REMOVE THE WIPER ARM.
- REMOVE THE GEARBOX COVER.
- REMOVE THE CLIP (1) ON THE CONNECTION LINK.
- REMOVE THE LINK AND THE GEAR.
- TURN THE GEAR OVER AND MOVE THE SWITCH PLATE.(2)
- LOOSEN THE FIXED SCREWS (3) AND TURN THE ANGLE PLATE (4) TO THE DESIRED DEGREES HOLE (THE HOLE OF ANGLE PLATE MUST BE ALIGNMENT THE GEAR CHANNEL (5) )
- TIGHTEN THE FIXED SCREWS.
- LOCATE THE SWITCH PLATE AND GEAR IN POSITION.
- PLACE THE TRANSMISSION PIN (6) IN DESIRED HOLE ON GEAR
- PLACE THE CLIP AND GEARBOX COVER.
- RUN THE MOTOR TO PARKED POSITION AND MOVE THE WIPER ARM.

## INSTALLATION DIAGRAM

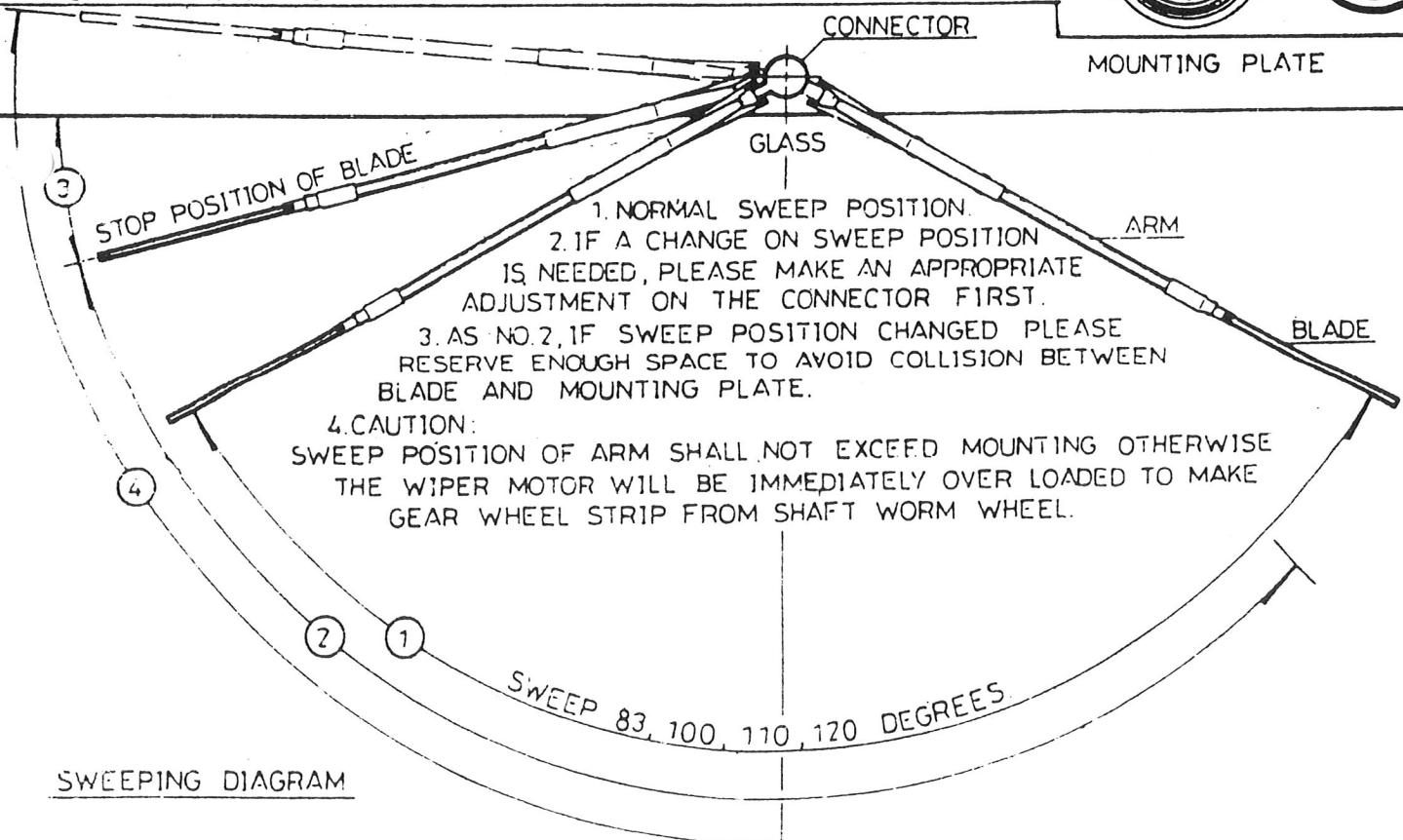
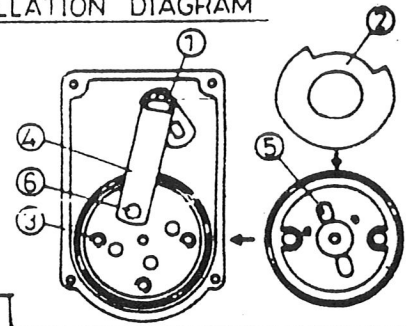

SWEEPING DIAGRAM